

B AC Motors

S.C. C&B Motor 15W (□ 80mm)

15W Speed Control Clutch & Brake Motor 15W(□ 80mm)

Motor 사양

Model		Output	Voltage	Frequency	Poles	Duty	Speed Range	Starting Torque		Permissible Torque				Capacitor
8CSDG*-15G-C(L): Gear Type Shaft								W	V	Hz	r/min	kgfcm	N.m	
Connector Type	Lead Wire Type								kgfcm	N.m	kgfcm	N.m	kgfcm	N.m
8CSDG1(A)-15G-C	8CSDG1(A)-15G-L	15	1φ110	60	4	Cont.	90-1700	0.70	0.070	1.50	0.150	0.45	0.045	3.5 / 250
8CSDGB-15G-C	8CSDGB-15G-L	15	1φ100	50	4	Cont.	90-1400	0.70	0.070	1.40	0.140	0.45	0.045	5.0 / 250
				60			90-1700	0.70	0.070	1.50	0.150	0.45	0.045	
8CSDGC-15G-C	8CSDGC-15G-L	15	1φ200	50	4	Cont.	90-1400	0.70	0.070	1.40	0.140	0.45	0.045	1.2 / 450
				60			90-1700	0.70	0.070	1.50	0.150	0.45	0.045	
8CSDG2(D)-15G-C	8CSDG2(D)-15G-L	15	1φ220	60	4	Cont.	90-1700	0.70	0.070	1.50	0.150	0.45	0.045	1.2 / 450
8CSDGE-15G-C	8CSDGE-15G-L	15	1φ220	50	4	Cont.	90-1400	0.65	0.065	1.20	0.120	0.43	0.043	1.2 / 450
			1φ240					0.70	0.070	1.40	0.140	0.45	0.045	

- 1) 모터 모델명 * 자리에는 전압코드가 들어갑니다.
- 2) 전압코드 A, B, C, D, E는 TP(Thermal Protector) 부착 사양입니다.
- 3) 스피드 컨트롤 클러치&브레이크 모터는 감속기를 부착하여 사용하여야 합니다. (모터 출력축: Gear Type Shaft)

감속기 부착 시 최대허용토크

Motor Model	Gear box Model	회전 속도 r/min	전압 V	주파수 Hz	감속비	3	3.6	5	6	7.5	9	10	12.5	15	18	20	25	30
8CSDG*-15G	8GBK □ BMH	1200	110	60	kgfcm	3.6	4.4	6.1	7.3	9.1	10.9	12.2	15.2	18.2	21.9	21.9	27.4	32.9
					N.m	0.36	0.43	0.60	0.71	0.89	1.07	1.19	1.49	1.79	2.14	2.15	2.68	3.22
					kgfcm	3.6	4.4	6.1	7.3	9.1	10.9	12.2	15.2	18.2	21.9	21.9	27.4	32.9
		90	220/240	50	kgfcm	3.4	4.1	5.7	6.8	8.5	10.2	11.3	14.2	17.0	20.4	20.4	25.6	30.7
					N.m	0.33	0.40	0.56	0.67	0.83	1.00	1.11	1.39	1.67	2.00	2.00	2.50	3.00
					kgfcm	1.1	1.3	1.8	2.2	2.7	3.3	3.6	4.6	5.5	6.6	6.6	8.2	9.9
90	220/240	60	kgfcm	1.1	1.3	1.8	2.2	2.7	3.3	3.6	4.6	5.5	6.6	6.6	8.2	9.9		
			N.m	0.11	0.13	0.18	0.21	0.27	0.32	0.36	0.45	0.54	0.64	0.64	0.80	0.97		
			kgfcm	1.1	1.3	1.8	2.2	2.7	3.3	3.6	4.6	5.5	6.6	6.6	8.2	9.9		
90	220/240	50	kgfcm	1.1	1.3	1.8	2.2	2.7	3.3	3.6	4.6	5.5	6.6	6.6	8.2	9.9		
			N.m	0.11	0.13	0.18	0.21	0.27	0.32	0.36	0.45	0.54	0.64	0.64	0.80	0.97		
			kgfcm	1.1	1.3	1.8	2.2	2.7	3.3	3.6	4.6	5.5	6.6	6.6	8.2	9.9		

Motor Model	Gear box Model	회전 속도 r/min	전압 V	주파수 Hz	감속비	36	40	50	60	75	90	100	120	150	180	200	250	300	360		
8CSDG*-15G	8GBK □ BMH	1200	110	60	kgfcm	39.4	43.8	49.5	59.4	74.3	80.0	80.0	80.0	80.0	80.0	80.0	80.0	80.0	80.0		
					N.m	3.86	4.29	4.85	5.82	7.28	7.84	7.84	7.84	7.84	7.84	7.84	7.84	7.84	7.84	7.84	
					kgfcm	39.4	43.8	49.5	59.4	74.3	80.0	80.0	80.0	80.0	80.0	80.0	80.0	80.0	80.0	80.0	80.0
			90	220/240	50	kgfcm	36.8	40.9	46.2	55.4	69.3	80.0	80.0	80.0	80.0	80.0	80.0	80.0	80.0	80.0	80.0
						N.m	3.61	4.01	4.53	5.43	6.79	7.84	7.84	7.84	7.84	7.84	7.84	7.84	7.84	7.84	7.84
						kgfcm	11.8	13.1	14.9	17.8	22.3	26.7	29.7	35.6	44.6	53.5	59.4	74.3	80.0	80.0	
		90	220/240	60	kgfcm	11.8	13.1	14.9	17.8	22.3	26.7	29.7	35.6	44.6	53.5	59.4	74.3	80.0	80.0		
					N.m	1.16	1.29	1.46	1.75	2.18	2.62	2.91	3.49	4.37	5.24	5.82	7.28	7.84	7.84		
					kgfcm	11.8	13.1	14.9	17.8	22.3	26.7	29.7	35.6	44.6	53.5	59.4	74.3	80.0	80.0		
		90	220/240	50	kgfcm	11.8	13.1	14.9	17.8	22.3	26.7	29.7	35.6	44.6	53.5	59.4	74.3	80.0	80.0		
					N.m	1.16	1.29	1.46	1.75	2.18	2.62	2.91	3.49	4.37	5.24	5.82	7.28	7.84	7.84		
					kgfcm	11.8	13.1	14.9	17.8	22.3	26.7	29.7	35.6	44.6	53.5	59.4	74.3	80.0	80.0		

- 1) 모터 모델명 * 자리에는 전압코드가 들어갑니다.
- 2) 감속기 모델명 □ 안에는 감속비가 들어갑니다.
- 3) 위의 표에서 색칠된 범위의 감속비를 선택했을 때 감속기의 출력축은 모터의 출력축과 같은 방향으로 회전합니다. 흰색 바탕 범위의 감속비에서는 감속기 출력축은 모터 출력축의 회전방향과 반대방향으로 회전합니다.

Dimensions

GEARED MOTOR

G TYPE GEARBOX

● MOTOR MODEL:
8CSDG□-15G

● GEARBOX MODEL:
8GBK□BMH

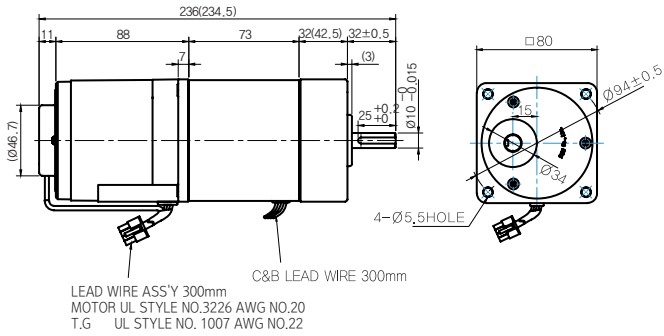

GEARBOX OUTPUT SHAFT

MODEL	SPEC
KEY TYPE	
8GBK□BMH	

32(42.5)-Table1

SIZE(mm)	GEAR RATIO
32	8GBK3BMH - 8GBK18BMH
42.5	8GBK20BMH - 8GBK360BMH

KEY SPEC

GEARBOX

중간감속기

● MODEL: 8XD10□□

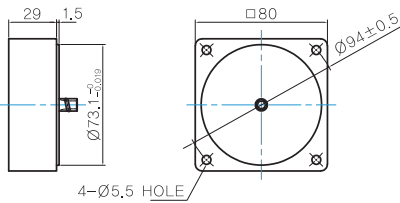

WEIGHT

PART		WEIGHT(kg)
MOTOR		2.83
GEAR BOX	8GBK3BMH - 8GBK18BMH	0.56
	8GBK20BMH - 8GBK40BMH	0.65
	8GBK50BMH - 8GBK360BMH	0.72
	8XD10□□	0.45

*출력 FLANGE와 SHAFT는 별매입니다.

Motor Images

8CSDG□-15G+8GBK□BMH



B AC Motors

S.C. C&B Motor 25W (□ 80mm)

25W Speed Control Clutch & Brake Motor 25W(□ 80mm)

Motor 사양

Model		Output W	Voltage V	Frequency Hz	Poles	Duty	Speed Range r/min	Starting Torque		Permissible Torque				Capacitor μF / VAC	
Connector Type	Lead Wire Type							kgfcm	N.m	1200r/min	90r/min	kgfcm	N.m		kgfcm
8CSDG*(A)-25G-C(L): Gear Type Shaft															
8CSDG1(A)-25G-C	8CSDG1(A)-25G-L	25	1φ110	60	4	Cont.	90-1700	1.00	0.100	1.70	0.170	0.60	0.060	6.0 / 250	
8CSDGB-25G-C	8CSDGB-25G-L	25	1φ100	50	4	Cont.	90-1400	0.80	0.800	1.50	0.150	0.50	0.050	6.0 / 250	
				60			90-1700	0.90	0.090	1.70	0.170	0.60	0.060		
8CSDGC-25G-C	8CSDGC-25G-L	25	1φ200	50	4	Cont.	90-1400	0.80	0.800	1.50	0.150	0.50	0.050	1.5 / 450	
				60			90-1700	0.90	0.090	1.70	0.170	0.60	0.060		
8CSDG2(D)-25G-C	8CSDG2(D)-25G-L	25	1φ220	60	4	Cont.	90-1700	1.00	0.100	1.80	0.180	0.60	0.060	1.5 / 450	
8CSDGE-25G-C	8CSDGE-25G-L	25	1φ220	50	4	Cont.	90-1400	0.80	0.080	1.50	0.150	0.50	0.050	1.5 / 450	
			1φ240					1.00	0.100	1.80	0.180	0.52	0.052		

- 1) 모터 모델명 * 자리에는 전압코드가 들어갑니다.
- 2) 전압코드 A, B, C, D, E는 TP(Thermal Protector) 부착 사양입니다.
- 3) 스피드 컨트롤 클러치&브레이크 모터는 감속기를 부착하여 사용하여야 합니다. (모터 출력축: Gear Type Shaft)

감속기 부착 시 최대허용토크

Motor Model	Gear box Model	회전 속도 r/min	전압 V	주파수 Hz	감속비	3	3.6	5	6	7.5	9	10	12.5	15	18	20	25	30
8CSDG*-25G	8GBK □ BMH	1200	110	60	kgfcm N.m	4.1 0.40	5.0 0.49	6.9 0.67	8.3 0.81	10.3 1.01	12.4 1.21	13.8 1.35	17.2 1.69	20.7 2.02	24.8 2.43	24.8 2.43	31.0 3.04	37.2 3.65
			220	60	kgfcm N.m	4.4 0.43	5.2 0.51	7.3 0.71	8.7 0.86	10.9 1.07	13.1 1.29	14.6 1.43	18.2 1.79	21.9 2.14	26.2 2.57	26.3 2.58	32.9 3.22	39.4 3.86
			220/ 240	50	kgfcm N.m	4.4 0.43	5.2 0.51	7.3 0.71	8.7 0.86	10.9 1.07	13.1 1.29	14.6 1.43	18.2 1.79	21.9 2.14	26.2 2.57	26.3 2.58	32.9 3.22	39.4 3.86
		90	110	60	kgfcm N.m	1.5 0.14	1.7 0.17	2.4 0.24	2.9 0.29	3.6 0.36	4.4 0.43	4.9 0.48	6.1 0.60	7.3 0.71	8.7 0.86	8.8 0.86	11.0 1.07	13.1 1.29
			220	60	kgfcm N.m	1.5 0.14	1.7 0.17	2.4 0.24	2.9 0.29	3.6 0.36	4.4 0.43	4.9 0.48	6.1 0.60	7.3 0.71	8.7 0.86	8.8 0.86	11.0 1.07	13.1 1.29
			220/ 240	50	kgfcm N.m	1.3 0.12	1.5 0.15	2.1 0.21	2.5 0.25	3.2 0.31	3.8 0.37	4.2 0.41	5.3 0.52	6.3 0.62	7.6 0.74	7.6 0.74	9.5 0.93	11.4 1.12

Motor Model	Gear box Model	회전 속도 r/min	전압 V	주파수 Hz	감속비	36	40	50	60	75	90	100	120	150	180	200	250	300	360	
8CSDG*-25G	8GBK □ BMH	1200	110	60	kgfcm N.m	44.7 4.38	49.6 4.86	56.1 5.50	67.3 6.60	80.0 7.84	80.0 7.84	80.0 7.84	80.0 7.84	80.0 7.84	80.0 7.84	80.0 7.84	80.0 7.84	80.0 7.84	80.0 7.84	
			220	60	kgfcm N.m	47.3 4.64	52.6 5.15	59.4 5.82	71.3 6.99	80.0 7.84	80.0 7.84	80.0 7.84	80.0 7.84	80.0 7.84	80.0 7.84	80.0 7.84	80.0 7.84	80.0 7.84	80.0 7.84	80.0 7.84
			220/ 240	50	kgfcm N.m	47.3 4.64	52.6 5.15	59.4 5.82	71.3 6.99	80.0 7.84	80.0 7.84	80.0 7.84	80.0 7.84	80.0 7.84	80.0 7.84	80.0 7.84	80.0 7.84	80.0 7.84	80.0 7.84	80.0 7.84
		90	110	60	kgfcm N.m	15.8 1.55	17.5 1.72	19.8 1.94	23.8 2.33	29.7 2.91	35.6 3.49	39.6 3.88	47.5 4.66	59.4 5.82	71.3 6.99	79.2 7.76	80.0 7.84	80.0 7.84	80.0 7.84	80.0 7.84
			220	60	kgfcm N.m	15.8 1.55	17.5 1.72	19.8 1.94	23.8 2.33	29.7 2.91	35.6 3.49	39.6 3.88	47.5 4.66	59.4 5.82	71.3 6.99	79.2 7.76	80.0 7.84	80.0 7.84	80.0 7.84	80.0 7.84
			220/ 240	50	kgfcm N.m	13.7 1.34	15.2 1.49	17.2 1.68	20.6 2.02	25.7 2.52	30.9 3.03	34.3 3.36	41.2 4.04	51.5 5.05	61.8 6.05	68.6 6.73	80.0 7.84	80.0 7.84	80.0 7.84	80.0 7.84

- 1) 모터 모델명 * 자리에는 전압코드가 들어갑니다.
- 2) 감속기 모델명 □ 안에는 감속비가 들어갑니다.
- 3) 위의 표에서 선택된 범위의 감속비를 선택했을 때 감속기의 출력축은 모터의 출력축과 같은 방향으로 회전합니다.
흰색 바탕 범위의 감속비에서는 감속기 출력축은 모터 출력축의 회전방향과 반대방향으로 회전합니다.

Dimensions

GEARED MOTOR

☉ G TYPE GEARBOX

● MOTOR MODEL:
8CSDG□-25G-C

● GEARBOX MODEL:
8GBK□BMH

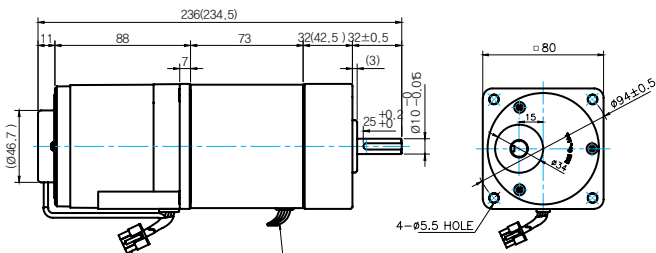

LEAD WIRE ASS'Y 300mm
MOTOR UL STYLE NO.3271 AWG NO.20
T.G UL STYLE NO. 1007 AWG NO.22

C&B LEAD WIRE 300mm

☉ 중간감속기

● MODEL:
8XD10□□

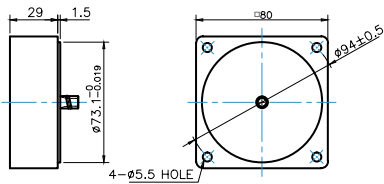

● GEARBOX OUTPUT SHAFT

MODEL	SPEC
KEY TYPE	32±0.5 25±0.2 10±0.015
8GBK□BMH	

● 32(42.5)-Table1

SIZE(mm)	GEAR RATIO
32	8GBK3BMH - 8GBK18BMH
42.5	8GBK20BMH - 8GBK360BMH

● KEY SPEC

GEARBOX	
4±0.03	2.5±0.1
25±0.2	4±0.03

☉ WEIGHT

PART		WEIGHT(kg)
MOTOR		2.83
GEAR BOX	8GBK3BMH - 8GBK18BMH	0.56
	8GBK20BMH - 8GBK40BMH	0.65
	8GBK50BMH - 8GBK360BMH	0.72
	8XD10□□	0.45

*출력 FLANGE와 SHAFT는 별매입니다.

Motor Images

8CSDG□-25G+8GBK□BMH



B AC Motors

S.C. C&B Motor 40W (□ 90mm)

40W Speed Control Clutch & Brake Motor 40W(□ 90mm)

Motor 사양

Model		Output	Voltage	Frequency	Poles	Duty	Speed Range	Starting Torque		Permissible Torque				Capacitor
9CSDG*-40G-C(L): Gear Type Shaft								W	V	Hz	r/min	kgfcm	N.m	
Connector Type	Lead Wire Type	kgfcm	N.m	kgfcm	N.m	kgfcm	N.m							
9CSDG1(A)-40□-C	9CSDG1(A)-40□-L	40	1ϕ110	60	4	Cont.	90-1700	1.80	0.180	2.70	0.270	0.80	0.080	10.0 / 250
9CSDGB-40□-C	9CSDGB-40□-L	40	1ϕ100	50	4	Cont.	90-1400	1.60	0.160	2.50	0.250	0.70	0.070	10.0 / 250
				60			90-1700	1.60	0.160	2.50	0.250	0.70	0.070	
9CSDGC-40□-C	9CSDGC-40□-L	40	1ϕ200	50	4	Cont.	90-1400	1.90	0.190	3.00	0.300	0.80	0.080	3.0 / 450
				60			90-1700	1.90	0.190	2.80	0.280	0.80	0.080	
9CSDG2(D)-40□-C	9CSDG2(D)-40□-L	40	1ϕ220	60	4	Cont.	90-1700	1.80	0.180	2.70	0.270	0.80	0.080	2.5 / 450
9CSDGE-40□-C	9CSDGE-40□-L	40	1ϕ220	50	4	Cont.	90-1400	1.50	0.150	2.50	0.250	0.70	0.070	2.5 / 450
			1ϕ240					1.80	0.180	3.00	0.300	0.72	0.072	

- 1) 모터 모델명 * 자리에는 전압코드가 들어갑니다.
- 2) 전압코드 A, B, C, D, E는 TP(Thermal Protector) 부착 사양입니다.
- 3) 스피드 컨트롤 클러치&브레이크 모터는 감속기를 부착하여 사용하여야 합니다. (모터 출력축: Gear Type Shaft)

감속기 부착 시 최대허용토크

Motor Model	Gear box Model	회전 속도 r/min	전압 V	주파수 Hz	감속비	2	3	3.6	5	6	7.5	9	10	12.5	15	18	20	25	30	36	40	50	60	75	90	100	120	150	180	200			
9CSDG*-40G	9GBK □ BMH	1200	110	60	kgfcm	4.4	6.6	7.9	10.9	13.1	16.4	19.7	21.9	27.3	32.8	39.4	39.4	49.3	59.1	71.0	78.8	89.1	100.0	100.0	100.0	100.0	100.0	100.0	100.0	100.0	100.0		
					N.m	0.43	0.64	0.77	1.07	1.29	1.61	1.93	2.14	2.68	3.21	3.86	3.86	4.83	5.79	6.95	7.73	8.73	9.80	9.80	9.80	9.80	9.80	9.80	9.80	9.80	9.80	9.80	9.80
					220/240	50	kgfcm	4.1	6.1	7.3	10.1	12.2	15.2	18.2	20.3	25.3	30.4	36.5	36.5	45.6	54.8	65.7	73.0	82.5	99.0	100.0	100.0	100.0	100.0	100.0	100.0	100.0	100.0
		N.m	0.40	0.60	0.71	0.99	1.19	1.49	1.79	1.98	2.48	2.98	3.57	3.58	4.47	5.37	6.44	7.15	8.09	9.70	9.80	9.80	9.80	9.80	9.80	9.80	9.80	9.80	9.80	9.80	9.80	9.80	
		90	60	kgfcm	1.3	1.9	2.3	3.2	3.9	4.9	5.8	6.5	8.1	9.7	11.7	14.6	17.5	21.0	23.4	26.4	31.7	39.6	47.5	52.8	63.4	79.2	95.0	100.0	100.0	100.0	100.0	100.0	100.0
				N.m	0.13	0.19	0.23	0.32	0.38	0.48	0.57	0.64	0.79	0.95	1.14	1.4	1.43	1.72	2.06	2.29	2.59	3.10	3.88	4.66	5.17	6.21	7.76	9.31	9.80	9.80	9.80	9.80	9.80
220/240	50			kgfcm	1.1	1.7	2.0	2.8	3.4	4.3	5.1	5.7	7.1	8.5	10.2	12.8	15.3	18.4	20.4	23.1	27.7	34.7	41.6	46.2	55.4	69.3	83.2	92.4	92.4	92.4	92.4		
N.m	0.11	0.17	0.20	0.28	0.33	0.42	0.50	0.56	0.69	0.83	1.00	1.00	1.25	1.50	1.80	2.00	2.26	2.72	3.40	4.07	4.53	5.43	6.79	8.15	9.06	9.06	9.06	9.06	9.06				

Motor Model	Gear box Model	회전 속도 r/min	전압 V	주파수 Hz	감속비	2	3	3.6	5	6	7.5	9	10	12.5	15	18	20	25	30	36	40	50	60	75	90	100	120	150	180	200	
9CSDG*-40P	9PBK □ BH	1200	110	60	kgfcm	4.4	6.6	7.9	10.9	13.1	16.4	19.7	21.9	24.6	29.6	35.5	39.4	44.6	53.5	64.2	71.3	89.1	106.9	119.5	143.4	159.3	191.2	200.0	200.0	200.0	
					N.m	0.43	0.64	0.77	1.07	1.29	1.61	1.93	2.14	2.41	2.90	3.48	3.86	4.37	5.24	6.29	6.99	8.73	10.48	11.71	14.05	15.61	18.73	19.60	19.60	19.60	19.60
					220/240	50	kgfcm	4.1	6.1	7.3	10.1	12.2	15.2	18.2	20.3	22.8	27.4	32.9	36.5	41.3	49.5	59.4	66.0	82.5	99.0	110.6	132.8	147.5	177.0	200.0	200.0
		N.m	0.40	0.60	0.71	0.99	1.19	1.49	1.79	1.98	2.24	2.68	3.22	3.58	4.04	4.85	5.82	6.47	8.09	9.70	10.84	13.01	14.46	17.35	19.60	19.60	19.60				
		90	60	kgfcm	1.3	1.9	2.3	3.2	3.9	4.9	5.8	6.5	7.3	8.8	10.5	11.7	13.2	15.8	19.0	21.1	26.4	31.7	35.4	42.5	47.2	56.6	70.8	85.0	94.4		
				N.m	0.13	0.19	0.23	0.32	0.38	0.48	0.57	0.64	0.72	0.86	1.03	1.14	1.29	1.55	1.86	2.07	2.59	3.10	3.47	4.16	4.63	5.55	6.94	8.33	9.25		
220/240	50			kgfcm	1.1	1.7	2.0	2.8	3.4	4.3	5.1	5.7	6.4	7.7	9.2	10.2	11.6	13.9	16.6	18.5	23.1	27.7	31.0	37.2	41.3	49.6	62.0	74.3	82.6		
N.m	0.11	0.17	0.20	0.28	0.33	0.42	0.50	0.56	0.63	0.75	0.90	1.00	1.13	1.36	1.63	1.81	2.26	2.72	3.04	3.64	4.05	4.86	6.07	7.29	8.09						

- 1) 모터 모델명 * 자리에는 전압코드가 들어갑니다.
- 2) 감속기 모델명 □ 안에는 감속비가 들어갑니다.
- 3) 위의 표에서 색칠된 범위의 감속비를 선택했을 때 감속기의 출력축은 모터의 출력축과 같은 방향으로 회전합니다. 흰색 바탕 범위의 감속비에서는 감속기 출력축은 모터 출력축의 회전방향과 반대방향으로 회전합니다.

Dimensions

GEARED MOTOR

G TYPE GEARBOX

- MOTOR MODEL:
9CSDG□-40G-C

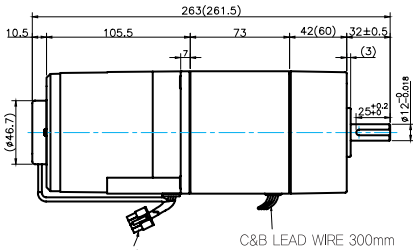

LEAD WIRE ASS'Y 300mm
MOTOR UL STYLE NO.3271 AWG NO.20
T,G UL STYLE NO.1430 AWG No.24

- GEARBOX MODEL:
9GBK□BMH

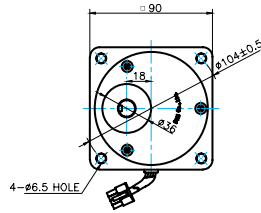

GEARBOX OUTPUT SHAFT

MODEL	SPEC
KEY TYPE	32±0.5
9GBK□BMH	25±0.2 φ12±0.08

42(60)-Table1

SIZE(mm)	GEAR RATIO
42	9GBK2BMH - 9GBK18BMH
60	9GBK20BMH - 9GBK200BMH

KEY SPEC

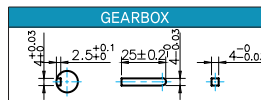

P TYPE GEARBOX

- MOTOR MODEL:
9CSDG□-40P-C

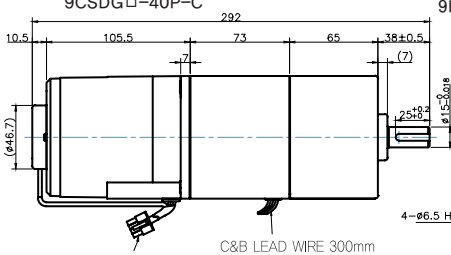

LEAD WIRE ASS'Y 300mm
MOTOR UL STYLE NO.3271 AWG NO.20
T,G UL STYLE NO.1430 AWG No.24

- GEARBOX MODEL:
9PBK□BH

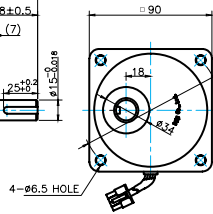

- GEARBOX MODEL:
9PFK□BH

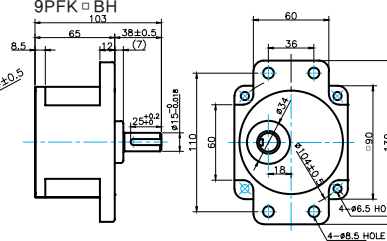

GEARBOX OUTPUT SHAFT

MODEL	SPEC
KEY TYPE	38±0.5 (7)
9PBK□BH 9PFK□BH	25±0.2 φ12±0.08

KEY SPEC

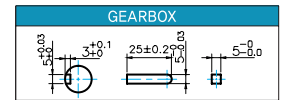

중간감속기

- MODEL:
9XD10□□

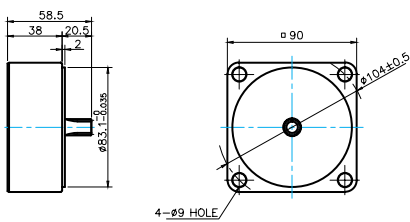

WEIGHT

PART	WEIGHT(kg)	
MOTOR	3.90	
GEAR BOX	9GBK2BMH - 9GBK18BMH	0.78
	9GBK20BMH - 9GBK40BMH	1.10
	9GBK50BMH - 9GBK200BMH	1.20
	9PB(F)K2BH - 9PB(F)K10BH	1.28
	9PB(F)K12.5BH - 9PB(F)K20BH	1.30
	9PB(F)K25BH - 9PB(F)K60BH	1.45
	9PB(F)K75BH - 9PB(F)K200BH	1.47
9XD10□□	0.60	

*출력 FLANGE와 SHAFT는 별매입니다.

Motor Images

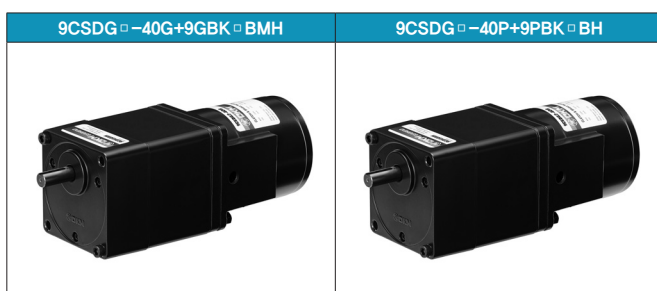

B AC Motors

S.C. C&B Motor 60W (□ 90mm)

60W Speed Control Clutch & Brake Motor 60W(□ 90mm)

Motor 사양

Model		Output	Voltage	Frequency	Poles	Duty	Speed Range	Starting Torque		Permissible Torque				Capacitor
9CSDG*-60F2P-C(L): Gear Type Shaft								W	V	Hz	r/min	kgfcm	N.m	
Connector Type	Lead Wire Type									kgfcm	N.m	kgfcm	N.m	
9CSDG1(A)-60F2P-C	9CSDG1(A)-60F2P-L	60	1ϕ110	60	4	Cont.	90-1700	4.00	0.400	5.50	0.550	1.60	0.160	16.0 / 250
9CSDGB-60F2P-C	9CSDGB-60F2P-L	60	1ϕ100	50	4	Cont.	90-1400	4.20	0.420	5.50	0.550	1.50	0.150	20.0 / 250
				60			90-1700	4.00	0.400	5.50	0.550	1.60	0.160	
9CSDGC-60F2P-C	9CSDGC-60F2P-L	60	1ϕ200	50	4	Cont.	90-1400	4.20	0.420	5.50	0.550	1.50	0.150	5.0 / 450
				60			90-1700	4.00	0.400	5.50	0.550	1.60	0.160	
9CSDG2(D)-60F2P-C	9CSDG2(D)-60F2P-L	60	1ϕ220	60	4	Cont.	90-1700	4.00	0.400	5.50	0.550	1.60	0.160	5.0 / 450
9CSDGE-60F2P-C	9CSDGE-60F2P-L	60	1ϕ220	50	4	Cont.	90-1400	4.00	0.400	5.20	0.520	1.40	0.140	5.0 / 450
			1ϕ240					4.50	0.450	5.80	0.580	1.60	0.160	

- 1) 모터 모델명 * 자리에는 전압코드가 들어갑니다.
- 2) 전압코드 A, B, C, D, E는 TP(Thermal Protector) 부착 사양입니다.
- 3) 스피드 컨트롤 클러치&브레이크 모터는 감속기를 부착하여 사용하여야 합니다. (모터 출력축: Gear Type Shaft)

감속기 부착 시 최대허용토크

Motor Model	Gear box Model	회전 속도 r/min	전압 V	주파수 Hz	감속비	2	3	3.6	5	6	7.5	9	10	12.5	15	18	20	25	30	36	40	50	60	75	90	100	120	150	180	200			
9CSDG*-60F2P	9PBK □BH	1200	110	60	kgfcm	8.9	13.4	16.0	22.3	26.7	33.4	40.1	44.6	50.2	60.2	72.3	80.3	90.8	108.9	130.7	145.2	181.5	200.0	200.0	200.0	200.0	200.0	200.0	200.0	200.0	200.0		
					N.m	0.87	1.31	1.57	2.18	2.62	3.27	3.93	4.37	4.92	5.90	7.08	7.87	8.89	10.67	12.81	14.23	17.79	19.60	19.60	19.60	19.60	19.60	19.60	19.60	19.60	19.60	19.60	19.60
					kgfcm	8.9	13.4	16.0	22.3	26.7	33.4	40.1	44.6	50.2	60.2	72.3	80.3	90.8	108.9	130.7	145.2	181.5	200.0	200.0	200.0	200.0	200.0	200.0	200.0	200.0	200.0	200.0	200.0
		N.m			0.87	1.31	1.57	2.18	2.62	3.27	3.93	4.37	4.92	5.90	7.08	7.87	8.89	10.67	12.81	14.23	17.79	19.60	19.60	19.60	19.60	19.60	19.60	19.60	19.60	19.60	19.60	19.60	19.60
		kgfcm			8.4	12.6	15.2	21.1	25.3	31.6	37.9	42.1	47.5	56.9	68.3	75.9	85.8	103.0	123.6	137.3	171.6	200.0	200.0	200.0	200.0	200.0	200.0	200.0	200.0	200.0	200.0	200.0	200.0
		N.m			0.83	1.24	1.49	2.06	2.48	3.10	3.71	4.13	4.65	5.58	6.70	7.44	8.41	10.09	12.11	13.45	16.82	19.60	19.60	19.60	19.60	19.60	19.60	19.60	19.60	19.60	19.60	19.60	19.60
	9PFBK □BH	1200	110	60	kgfcm	2.6	3.9	4.7	6.5	7.8	9.7	11.7	13.0	14.6	17.5	21.0	23.4	26.4	31.7	38.0	42.2	52.8	63.4	70.8	85.0	94.4	113.3	141.6	169.9	188.8	188.8		
					N.m	0.25	0.38	0.46	0.64	0.76	0.95	1.14	1.27	1.43	1.72	2.06	2.29	2.59	3.10	3.73	4.14	5.17	6.21	6.94	8.33	9.25	11.10	13.88	16.65	18.50	18.50		
					kgfcm	2.6	3.9	4.7	6.5	7.8	9.7	11.7	13.0	14.6	17.5	21.0	23.4	26.4	31.7	38.0	42.2	52.8	63.4	70.8	85.0	94.4	113.3	141.6	169.9	188.8	188.8		
		N.m			0.25	0.38	0.46	0.64	0.76	0.95	1.14	1.27	1.43	1.72	2.06	2.29	2.59	3.10	3.73	4.14	5.17	6.21	6.94	8.33	9.25	11.10	13.88	16.65	18.50	18.50			
		kgfcm			2.3	3.4	4.1	5.7	6.8	8.5	10.2	11.3	12.8	15.3	18.4	20.4	23.1	27.7	33.3	37.0	46.2	55.4	62.0	74.3	82.6	99.1	123.9	148.7	165.2	165.2			
		N.m			0.22	0.33	0.40	0.56	0.67	0.83	1.00	1.11	1.25	1.50	1.80	2.00	2.26	2.72	3.26	3.62	4.53	5.43	6.07	7.29	8.09	9.71	12.14	14.57	16.19	16.19			

- 1) 모터 모델명 * 자리에는 전압코드가 들어갑니다.
- 2) 감속기 모델명 □ 안에는 감속비가 들어갑니다.
- 3) 위의 표에서 색깔된 범위의 감속비를 선택했을 때 감속기의 출력축은 모터의 출력축과 같은 방향으로 회전합니다. 흰색 바탕 범위의 감속비에서는 감속기 출력축은 모터 출력축의 회전방향과 반대방향으로 회전합니다.

Dimensions

GEARED MOTOR

P TYPE GEARBOX

- MOTOR MODEL:
9CSDG□-60F2P-C

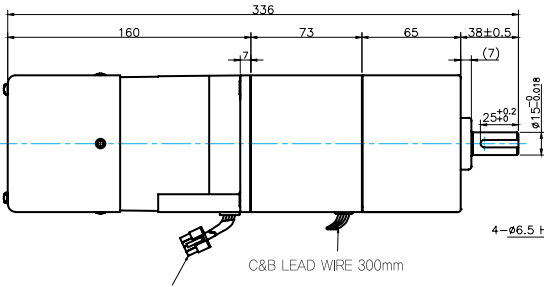

LEAD WIRE ASS Y 300mm
MOTOR UL STYLE NO.3271 AWG NO.20
T,G UL STYLE NO.1430 AWG NO.24

- GEARBOX MODEL:
9PBK□BH

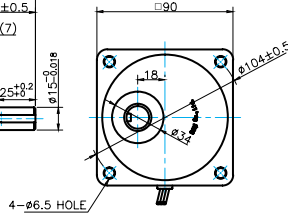

GEARBOX OUTPUT SHAFT

MODEL	SPEC
KEY TYPE	
9PBK□BH 9PFK□BH	

- GEARBOX MODEL:
9PFK□BH

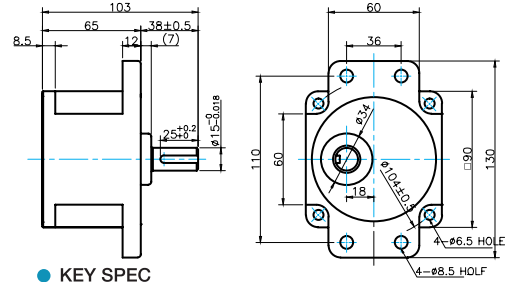

KEY SPEC

GEARBOX

중간감속기

- MODEL:
9XD10□□

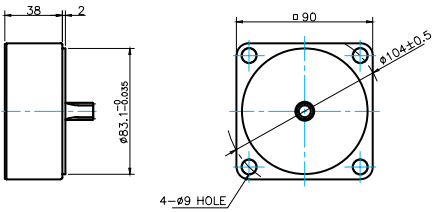

WEIGHT

	PART	WEIGHT(kg)
GEAR BOX	MOTOR	4.50
	9PB(F)K2BH - 9PB(F)K10BH	1.28
	9PB(F)K12.5BH - 9PB(F)K20BH	1.30
	9PB(F)K25BH - 9PB(F)K60BH	1.45
	9PB(F)K75BH - 9PB(F)K200BH	1.47
	9XD10□□	0.60

*출력 FLANGE와 SHAFT는 별매입니다.

Motor Images

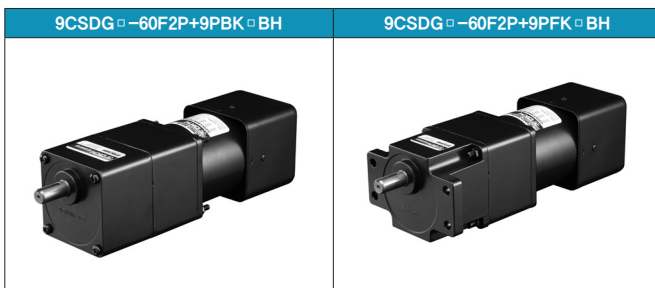

B AC Motors

S.C. C&B Motor 90W (□ 90mm)

90W Speed Control Clutch & Brake Motor 90W(□ 90mm)

Motor 사양

Model 9CSDG*-90F2P-C(L): Gear Type Shaft		Output W	Voltage V	Frequency Hz	Poles	Duty	Speed Range r/min	Starting Torque		Permissible Torque				Capacitor μF / VAC
Connector Type	Lead Wire Type							kgfcm	N.m	1200r/min		90r/min		
									kgfcm	N.m	kgfcm	N.m		
9CSDG1(A)-90F2P-C	9CSDG1(A)-90F2P-L	90	1ϕ110	60	4	Cont.	90-1700	4.50	0.450	6.30	0.630	2.30	0.230	20.0 / 250
9CSDGB-90F2P-C	9CSDGB-90F2P-L	90	1ϕ100	50	4	Cont.	90-1400	4.70	0.470	5.80	0.580	2.20	0.220	25.0 / 250
				60			90-1700	4.50	0.450	6.30	0.630	2.30	0.230	
9CSDGC-90F2P-C	9CSDGC-90F2P-L	90	1ϕ200	50	4	Cont.	90-1400	4.70	0.470	5.80	0.580	2.20	0.220	6.0 / 450
				60			90-1700	4.50	0.450	6.30	0.630	2.30	0.230	
9CSDG2(D)-90F2P-C	9CSDG2(D)-90F2P-L	90	1ϕ220	60	4	Cont.	90-1700	4.50	0.450	6.30	0.630	2.30	0.230	6.0 / 450
9CSDGE-90F2P-C	9CSDGE-90F2P-L	90	1ϕ220	50	4	Cont.	90-1400	4.50	0.450	5.40	0.540	2.20	0.220	6.0 / 450
			1ϕ240					5.00	0.500	6.10	0.610	2.30	0.230	

- 1) 모터 모델명 * 자리에에는 전압코드가 들어갑니다.
- 2) 전압코드 A, B, C, D, E는 TP(Thermal Protector) 부착 사양입니다.
- 3) 스피드 컨트롤 클러치&브레이크 모터는 감속기를 부착하여 사용하여야 합니다. (모터 출력축: Gear Type Shaft)

감속기 부착 시 최대허용토크

Motor Model	Gear box Model	회전 속도 r/min	전압 V	주파수 Hz	감속비	2	3	3.6	5	6	7.5	9	10	12.5	15	18	20	25	30	36	40	50	60	75	90	100	120	150	180	200			
9CSDG*-90F2P	9PBK □ BH	1200	110	60	kgfcm	10.2	15.3	18.4	25.5	30.6	38.3	45.9	51.0	57.5	69.0	82.8	92.0	104.0	124.7	149.7	166.3	200.0	200.0	200.0	200.0	200.0	200.0	200.0	200.0	200.0			
					N.m	1.00	1.50	1.80	2.50	3.00	3.75	4.50	5.00	5.63	6.76	8.11	9.01	10.19	12.22	14.67	16.30	19.60	19.60	19.60	19.60	19.60	19.60	19.60	19.60	19.60	19.60	19.60	19.60
					kgfcm	10.2	15.3	18.4	25.5	30.6	38.3	45.9	51.0	57.5	69.0	82.8	92.0	104.0	124.7	149.7	166.3	200.0	200.0	200.0	200.0	200.0	200.0	200.0	200.0	200.0	200.0	200.0	200.0
		N.m	1.00	1.50	1.80	2.50	3.00	3.75	4.50	5.00	5.63	6.76	8.11	9.01	10.19	12.22	14.67	16.30	19.60	19.60	19.60	19.60	19.60	19.60	19.60	19.60	19.60	19.60	19.60	19.60	19.60		
		kgfcm	8.7	13.1	15.7	21.9	26.2	32.8	39.4	43.7	49.3	59.1	71.0	78.8	89.1	106.9	128.3	142.6	178.2	200.0	200.0	200.0	200.0	200.0	200.0	200.0	200.0	200.0	200.0	200.0	200.0		
		N.m	0.86	1.29	1.54	2.14	2.57	3.21	3.86	4.29	4.83	5.79	6.95	7.73	8.73	10.48	12.57	13.97	17.46	19.60	19.60	19.60	19.60	19.60	19.60	19.60	19.60	19.60	19.60	19.60	19.60		
	9PFB □ BH	90	110	60	kgfcm	3.7	5.6	6.7	9.3	11.2	14.0	16.8	18.6	21.0	25.2	30.2	33.6	38.0	45.5	54.6	60.7	75.9	91.1	101.8	122.1	135.7	162.8	200.0	200.0	200.0	200.0		
					N.m	0.37	0.55	0.66	0.91	1.10	1.37	1.64	1.83	2.06	2.47	2.96	3.29	3.72	4.46	5.36	5.95	7.44	8.93	9.97	11.97	13.30	15.96	19.60	19.60	19.60	19.60	19.60	
					kgfcm	3.7	5.6	6.7	9.3	11.2	14.0	16.8	18.6	21.0	25.2	30.2	33.6	38.0	45.5	54.6	60.7	75.9	91.1	101.8	122.1	135.7	162.8	200.0	200.0	200.0	200.0	200.0	200.0
		N.m	0.37	0.55	0.66	0.91	1.10	1.37	1.64	1.83	2.06	2.47	2.96	3.29	3.72	4.46	5.36	5.95	7.44	8.93	9.97	11.97	13.30	15.96	19.60	19.60	19.60	19.60	19.60	19.60			
		kgfcm	3.6	5.3	6.4	8.9	10.7	13.4	16.0	17.8	20.1	24.1	28.9	32.1	36.3	43.6	52.3	58.1	72.6	87.1	97.4	116.8	129.8	155.8	194.7	200.0	200.0	200.0	200.0	200.0			
		N.m	0.35	0.52	0.63	0.87	1.05	1.31	1.57	1.75	1.97	2.36	2.83	3.15	3.56	4.27	5.12	5.69	7.11	8.54	9.54	11.45	12.72	15.26	19.08	19.60	19.60	19.60	19.60	19.60			

- 1) 모터 모델명 * 자리에에는 전압코드가 들어갑니다.
- 2) 감속기 모델명 □ 안에는 감속비가 들어갑니다.
- 3) 위의 표에서 색칠된 범위의 감속비를 선택했을 때 감속기의 출력축은 모터의 출력축과 같은 방향으로 회전합니다.
흰색 바탕 범위의 감속비에서는 감속기 출력축은 모터 출력축의 회전방향과 반대방향으로 회전합니다.

Dimensions

GEARED MOTOR

P TYPE GEARBOX

● MOTOR MODEL:
9CSDG□-90F2P-C

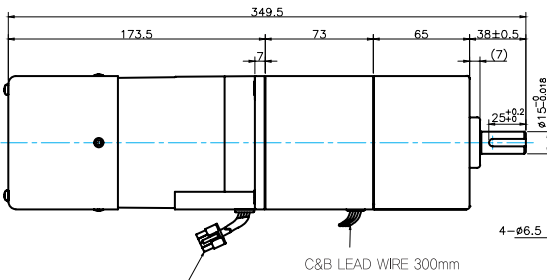

LEAD WIRE ASS Y 300mm
MOTOR UL STYLE NO,3271 AWG NO,20
T.G UL STYLE NO,1430 AWG No,24

● GEARBOX MODEL:
9PBK□BH

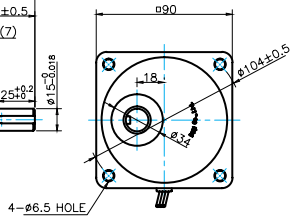

● GEARBOX OUTPUT SHAFT

MODEL	SPEC
KEY TYPE	
9PBK□BH 9PFK□BH	

● GEARBOX MODEL:
9PFK□BH

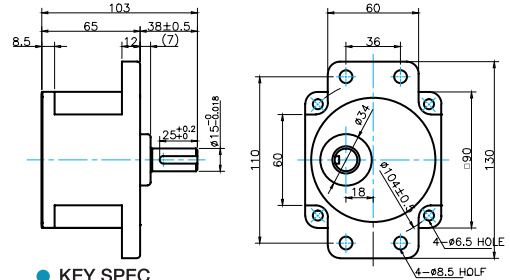

● KEY SPEC

GEARBOX	

중간감속기

● MODEL:
9XD10□□

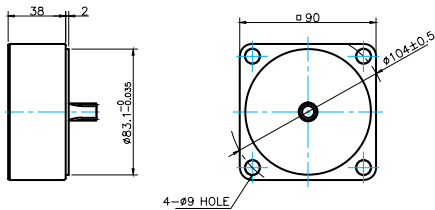

WEIGHT

PART		WEIGHT(kg)
MOTOR		4.85
GEAR BOX	9PB(F)K2BH - 9PB(F)K10BH	1.28
	9PB(F)K12.5BH - 9PB(F)K20BH	1.30
	9PB(F)K25BH - 9PB(F)K60BH	1.45
	9PB(F)K75BH - 9PB(F)K200BH	1.47
	9XD10□□	0.60

*출력 FLANGE와 SHAFT는 별매입니다.

Motor Images

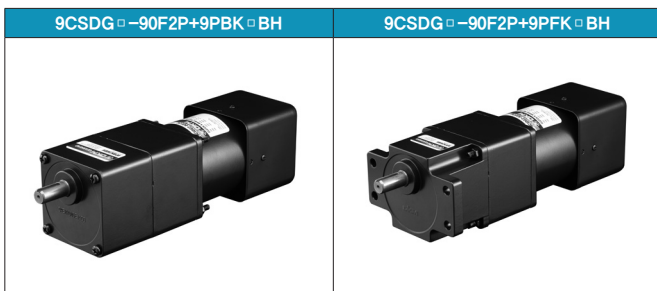

B AC Motors

S.C. C&B Motor 120W (□ 90mm)

120W Speed Control Clutch & Brake Motor 120W(□ 90mm)

Motor 사양

Model		Output	Voltage	Frequency	Poles	Duty	Speed Range	Starting Torque		Permissible Torque				Capacitor
9CSDG*-120F2P-C(L): Gear Type Shaft								W	V	Hz	r/min	kgfcm	N.m	
Connector Type	Lead Wire Type	kgfcm	N.m	kgfcm	N.m									
9CSDG1(A)-120F2P-C	9CSDG1(A)-120F2P-L	120	1ϕ110	60	4	Cont.	90-1700	5.70	0.570	8.30	0.830	2.80	0.280	25.0 / 250
9CSDG2(D)-120F2P-C	9CSDG2(D)-120F2P-L	120	1ϕ220	60	4	Cont.	90-1700	5.70	0.570	8.30	0.830	2.80	0.280	6.0 / 400
9CSDGE-120F2P-C	9CSDGE-120F2P-L	120	1ϕ220	50	4	Cont.	90-1400	5.70	0.570	8.00	0.800	2.80	0.280	6.0 / 400
			1ϕ240					6.20	0.620	8.60	0.860	2.90	0.290	

- 1) 모터 모델명 * 자리에는 전압코드가 들어갑니다.
- 2) 전압코드 A, D, E는 TP(Thermal Protector) 부착 사양입니다.
- 3) 스피드 컨트롤 클러치&브레이크 모터는 감속기를 부착하여 사용하여야 합니다. (모터 출력축: Gear Type Shaft)

감속기 부착 시 최대허용토크

Motor Model	Gear box Model	회전 속도 r/min	전압 V	주파수 Hz	감속비	2	3	3.6	5	6	7.5	9	10	12.5	15	18	20	25	30	36	40	50	60	75	90	100	120	150	180	200			
9CSDG*-120F2P	9PBK □ BH	1200	110	60	kgfcm	13.4	20.2	24.2	33.6	40.3	50.4	60.5	67.2	75.7	90.9	109.1	121.2	137.0	164.3	197.2	200.0	200.0	200.0	200.0	200.0	200.0	200.0	200.0	200.0	200.0	200.0		
					N.m	1.32	1.98	2.37	3.29	3.95	4.94	5.93	6.59	7.42	8.91	10.69	11.88	13.42	16.11	19.33	19.60	19.60	19.60	19.60	19.60	19.60	19.60	19.60	19.60	19.60	19.60	19.60	19.60
		220/240	50	kgfcm	13.4	20.2	24.2	33.6	40.3	50.4	60.5	67.2	75.7	90.9	109.1	121.2	137.0	164.3	197.2	200.0	200.0	200.0	200.0	200.0	200.0	200.0	200.0	200.0	200.0	200.0	200.0	200.0	200.0
				N.m	1.32	1.98	2.37	3.29	3.95	4.94	5.93	6.59	7.42	8.91	10.69	11.88	13.42	16.11	19.33	19.60	19.60	19.60	19.60	19.60	19.60	19.60	19.60	19.60	19.60	19.60	19.60	19.60	19.60
		9PFK □ BH	1200	110	60	kgfcm	13.0	19.4	23.3	32.4	38.9	48.6	58.3	64.8	73.0	87.6	105.1	116.8	132.0	158.4	190.1	200.0	200.0	200.0	200.0	200.0	200.0	200.0	200.0	200.0	200.0	200.0	200.0
						N.m	1.27	1.91	2.29	3.18	3.81	4.76	5.72	6.35	7.15	8.58	10.30	11.45	12.94	15.52	18.63	19.60	19.60	19.60	19.60	19.60	19.60	19.60	19.60	19.60	19.60	19.60	19.60
	220/240		50	kgfcm	4.5	6.8	8.2	11.3	13.6	17.0	20.4	22.7	25.6	30.7	36.8	40.9	46.2	55.4	66.5	73.9	92.4	110.9	123.9	148.7	165.2	198.2	200.0	200.0	200.0	200.0	200.0	200.0	200.0
				N.m	0.44	0.67	0.80	1.11	1.33	1.67	2.00	2.22	2.50	3.00	3.61	4.01	4.53	5.43	6.52	7.24	9.06	10.87	12.14	14.57	16.19	19.43	19.60	19.60	19.60	19.60	19.60	19.60	19.60
	220/240		50	kgfcm	4.5	6.8	8.2	11.3	13.6	17.0	20.4	22.7	25.6	30.7	36.8	40.9	46.2	55.4	66.5	73.9	92.4	110.9	123.9	148.7	165.2	198.2	200.0	200.0	200.0	200.0	200.0	200.0	200.0
				N.m	0.44	0.67	0.80	1.11	1.33	1.67	2.00	2.22	2.50	3.00	3.61	4.01	4.53	5.43	6.52	7.24	9.06	10.87	12.14	14.57	16.19	19.43	19.60	19.60	19.60	19.60	19.60	19.60	19.60

- 1) 모터 모델명 * 자리에는 전압코드가 들어갑니다.
- 2) 감속기 모델명 □ 안에는 감속비가 들어갑니다.
- 3) 위의 표에서 색칠된 범위의 감속비를 선택했을 때 감속기의 출력축은 모터의 출력축과 같은 방향으로 회전합니다. 흰색 바탕 범위의 감속비에서는 감속기 출력축은 모터 출력축의 회전방향과 반대방향으로 회전합니다.

Dimensions

GEARED MOTOR

○ P TYPE GEARBOX

● MOTOR MODEL:
9CSDG□-120F2P-C

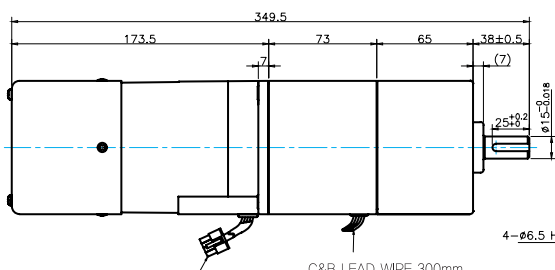

LEAD WIRE ASS Y 300mm
MOTOR UL STYLE NO.3271 AWG NO.20
T,G UL STYLE NO.1430 AWG NO.24

● GEARBOX MODEL:
9PBK□BH

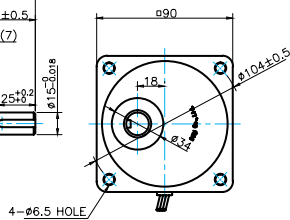

● GEARBOX OUTPUT SHAFT

MODEL	SPEC
KEY TYPE	
9PBK□BH	
9PFB□BH	

● GEARBOX MODEL:
9PFB□BH

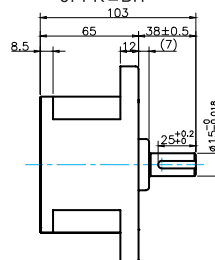

● KEY SPEC

GEARBOX	

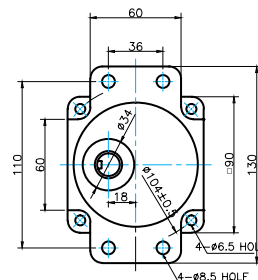

○ 중간감속기

● MODEL:
9XD10□□

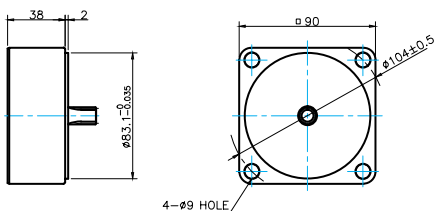

○ WEIGHT

PART		WEIGHT(kg)
MOTOR		4.85
GEAR BOX	9PB(F)K2BH - 9PB(F)K10BH	1.28
	9PB(F)K12.5BH - 9PB(F)K20BH	1.30
	9PB(F)K25BH - 9PB(F)K60BH	1.45
	9PB(F)K75BH - 9PB(F)K200BH	1.47
	9XD10□□	0.60

*출력 FLANGE와 SHAFT는 별매입니다.

Motor Images

